

Preventing Mortar from Breaking Drills and Taps

Coordinate with the anchoring and hollow metal supplier before installation.

www.markar.com

Dulling and breaking of taps and drills can be avoided by coordinating efforts with anchoring and hollow metal suppliers before installation begins.

Markar recommends placing a 1/4" or 3/8" strip of expanded polystyrene insulation on the back of the hollow metal frames (as illustrated below). When the frames are grouted in, the foam backer will allow drilling and tapping without dulling or breaking. (Making you a hero with installers and contractors!)

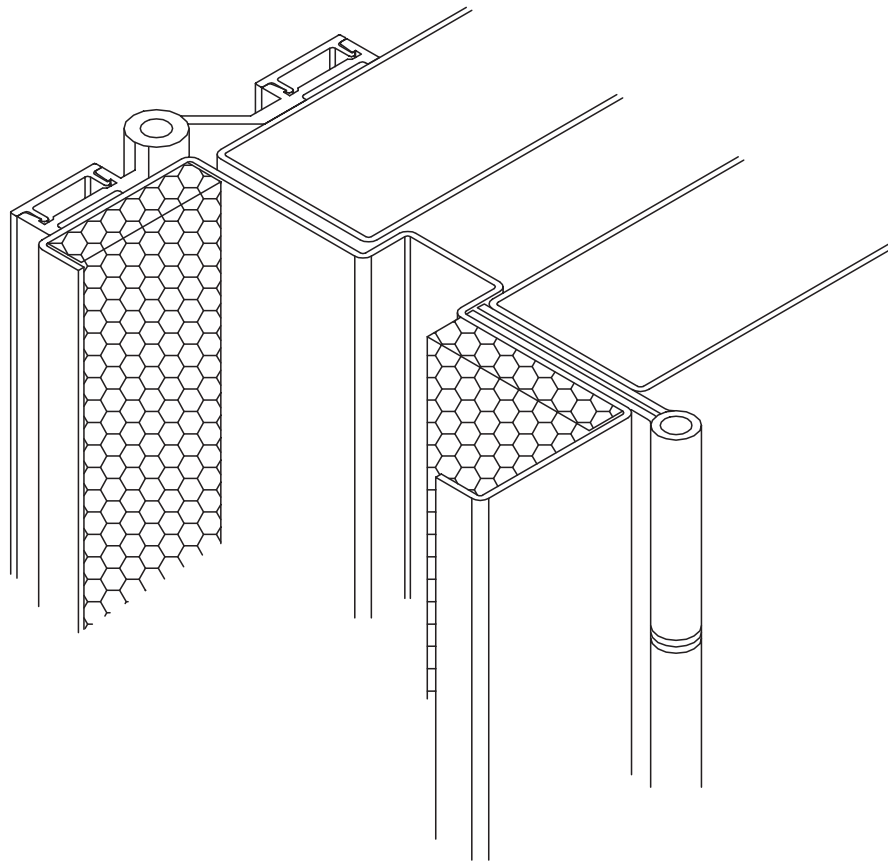

ASSA ABLOY

260 Santa Fe Street, Pomona, California 91767
800-872-3267 ■ fax 800-232-6752

ASSA ABLOY, the global leader
in door opening solutions