



ASSA ABLOY

HG-105 Hinge/Guard

Markar Architectural Products, Inc. a subsidiary of Adams Rite Manufacturing Co.
260 Santa Fe Street, Pomona, CA 91767 • 800-872-3267 • 909-632-2300 • 800-232-6752 fax • www.markar.com

STANDARD FEATURES

Material

6063-T6 aluminum

Finishes

Satin Anodized (628)
Dark Bronze Anodized (313)

Cycle Testing

Grade 2
ANSI/BHMA Standard A156.26

Mounting Hardware

No exposed mounting fasteners when closed
Universal screw pack
AdjustaScrews for correcting frame fit problems up to 3/8"

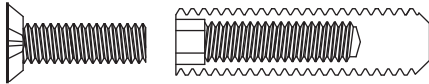

Capacity

Supports weights up to 600lbs.
4'0" maximum door width

Sizes

6'8", 7'0", 7'2", 8'0"

Hole Pattern

Symmetrically templated
Non-handed

Barrel Type Hinge

1/4" diameter Teflon-coated stainless steel pin
Long-life split nylon bearings

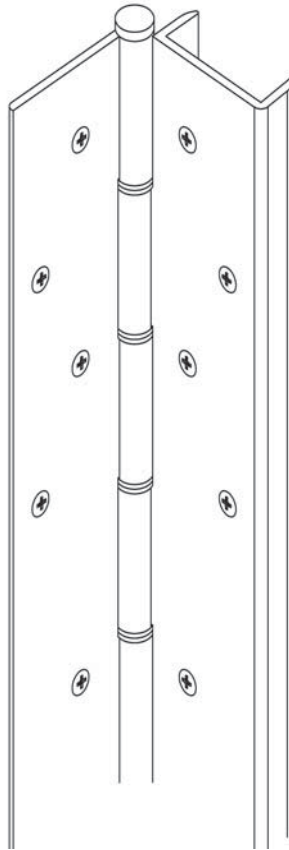

OPTIONAL FEATURES

Finishes

Light Bronze Anodized (311)
Black Anodized (315)
Scratch-Resistant Powder Coated Paint

Other Features

Custom lengths - specify in inches
Custom hole pattern
Dutch door hinges - suffix hinge "DD"
Hospital tips - suffix hinge "HT"

Fasteners

Tamper-proof security screws

Electrical Modifications

Exposed switch with adjusting screw - suffix hinge "ES"
Current Transfer Prep - suffix hinge "CTP"

This pin and barrel edge-mounted hinge can be used in conjunction with automatically operated aluminum doors that have heavy cart traffic through them. Ideal for both commercial and institutional doors, shipping and receiving doors, as well as storefronts where door edge protection is critical. The AdjustaScrew fastener allows adjustment of the door in the frame to assure alignment of magnetic locks, access control systems and associated hardware.

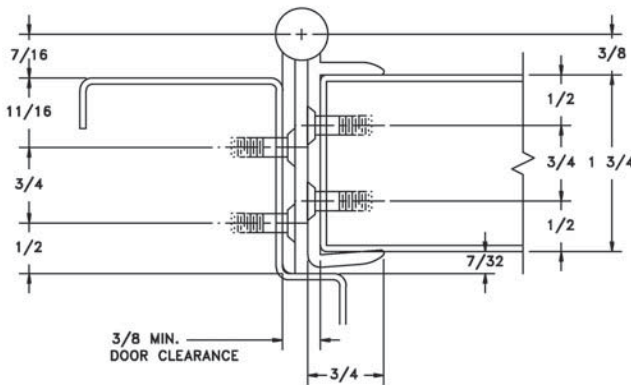

DOOR CLOSED

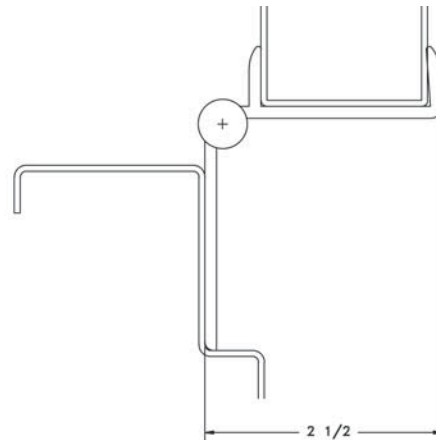

DOOR OPEN 90°